



# DISNEY'S HOTEL NEW YORK, CONVENTION CENTRE

Experience business differently



BUSINESS  
SOLUTIONS  
Disney

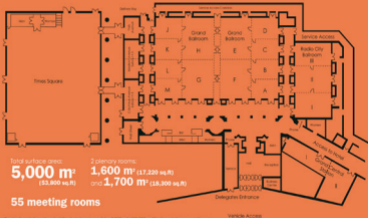

Total surface area:  
**5,000 m<sup>2</sup>**  
(53,800 sq.ft)

2 plenary rooms:  
**1,600 m<sup>2</sup>** (17,320 sq.ft)  
and **1,700 m<sup>2</sup>** (18,300 sq.ft)

**55 meeting rooms**

Disney's Hotel New York - Convention Centre is an integral part of the hotel and provides 5,000 m<sup>2</sup> (53,800 sq.ft) of modular space. It can accommodate between 10 and 3,200 people and the various areas can be configured for meetings, lunches, gala dinners and shows. The Convention Centre has its own reception dedicated to conference delegates, a welcome desk and a 400 m<sup>2</sup> (4,300 sq.ft) foyer for coffee breaks and cocktail receptions. In keeping with the theme of the hotel, the meeting rooms are decorated in the same 1930s New York Art Deco style. The ambience is one of elegance, luxury and calm - highly conducive for business.

Illustration for information purposes only. Scale plan available on request.



For further information or a quote, contact our Business advisers:

+33 (0)1 60 45 75 00 // [dtp.business@disney.com](mailto:dtp.business@disney.com) // [www.disneylandparis-business.com](http://www.disneylandparis-business.com)



# DISNEY'S HOTEL NEW YORK, CONVENTION CENTRE

Experience business differently



AREA	DIMENSIONS			CAPACITY*					
	SURFACE (M <sup>2</sup> )	(SQ FEET)	METERS W x L x H	THEATER	CLASSROOM	BOARDROOM	U	BANQUET**	RECEPTION
<b>Grand ballroom (Salons ABCDEFGHIJKL)</b>	1,400	17,220	32 x 50 x 6.75	2,100	1,100	-	-	940	2,000
Salons ABCDEFGH or EFGHIJKLM	1,240	13,540	31 x 40.4 x 6.75	1,300	700	-	-	800	2,020
Salons EFGH	700	9,900	29 x 31.7 x 6.75	1,040	640	-	-	560	1,480
Salons ABCDEF or GHIJKL	730	8,070	23.4 x 32 x 6.75	800	580	-	-	400	1,200
Salons EF or GH	410	4,410	12.8 x 32 x 6.75	480	270	-	-	240	640
Salons AB, CDE, HIJ or GJM	375	4,040	16 x 23.4 x 6.75	400	200	-	-	210	600
Salons ABCD or JKLM	336	3,620	10.9 x 32 x 6.75	410	240	-	-	230	540
Salons ABC, EFG, IJKL or GJM	282	2,710	10.9 x 24 x 6.75	300	180	-	-	180	410
Salon E, F, G or H	208	2,210	12.8 x 16 x 6.75	240	120	56	44	120	300
Salons AB, BC, CD, JK, KL, GJLM	170	1,830	16 x 10.4 x 6.75	180	120	60	40	100	280
Salon A, B, C, D, J, K, L or G, M	88	910	8 x 10.4 x 6.75	100	60	36	30	60	140
<b>Times Square</b>	1,700	18,300	37 x 53 x 11	2,000	1,000	-	-	1,870	2,000
<b>Radio City Ballroom (Halls I+G+H)</b>	490	4,840	18 x 30 x 8.85	600	300	-	-	300	720
Halls H+I or G+H	300	2,330	12 x 20 x 4.63	360	200	72	40	200	480
Halls G, I or H	190	1,410	10 x 12 x 4.65	180	90	48	40	80	240
<b>Columbus (Salons I+H)</b>	90	870	4 x 19 x 3.65	80	60	40	30	60	150
Salon I or H	45	460	4 x 7.5 x 3.65	35	30	20	20	30	75
<b>Madison Avenue (Salons I+H)</b>	90	870	4 x 19 x 3.65	80	60	40	30	60	150
Salon I or H	45	460	4 x 7.5 x 3.65	35	30	20	20	30	75
<b>Park Avenue</b>	90	840	4 x 18.3 x 3.65	40	34	24	24	30	60
Wall Street Boardroom	50	540	4 x 8.3 x 3.65	-	-	12	-	-	-
<b>Grand Central Station (Salons I+H)</b>	200	2,140	11.77 x 19.75 x 3.8	160	120	64	44	110	300
Salon I	110	1,160	7.54 x 13.43 x 3.8	102	72	38	40	60	-
Salon H	90	870	4.32 x 11.77 x 3.8	81	56	30	40	50	-
<b>Business Suites</b>									
Suite 3244	81	870	7.35 x 11 x 3.5	50	30	30	27	30	50
Long Island 2230	64	690	8 x 8 x 2.6	19	15	18	15	19	19
Manhattan 2230	64	690	8 x 8 x 2.6	19	15	18	15	19	19
Brooklyn 4230	64	690	8 x 8 x 2.6	19	15	18	15	19	19
14 Suites	45 to 84	480 to 610	-	12 to 20	-	12 to 18	10 to 15	10 to 19	-

\*Figures for guidance only

\*\*Tables and 10-chairs/seat

